

MILSMITH

116 East 27th Street, 3rd Floor | New York, NY 10016 | 212-685-6400

FEATURED: 213 West 35th Street

Second Floor

Entire 2nd Floor:

- 7,348.00 SFT

Rental:

- UPON REQUEST

Features:

- Attended Lobby
- Tenant Controlled HVAC
- 3 Passenger elevators
- Close proximity to Penn Station
- Verizon Fios Telecom Provider
- Full furnished (steelcase Avenir), and wired: PLUG & PLAY READY
- Brand new build out
- Drop Ceiling, independently cooled IT room, great for “back of the house” operation

Possession:

- Arranged

Location:

- Between 7th Avenue and 8th Avenue on 35th Street

Transit:

- B, D, F, M, N, Q, R, A, C, E



FLOOR PLAN: 2ND FLOOR - 7,348.00 SFT

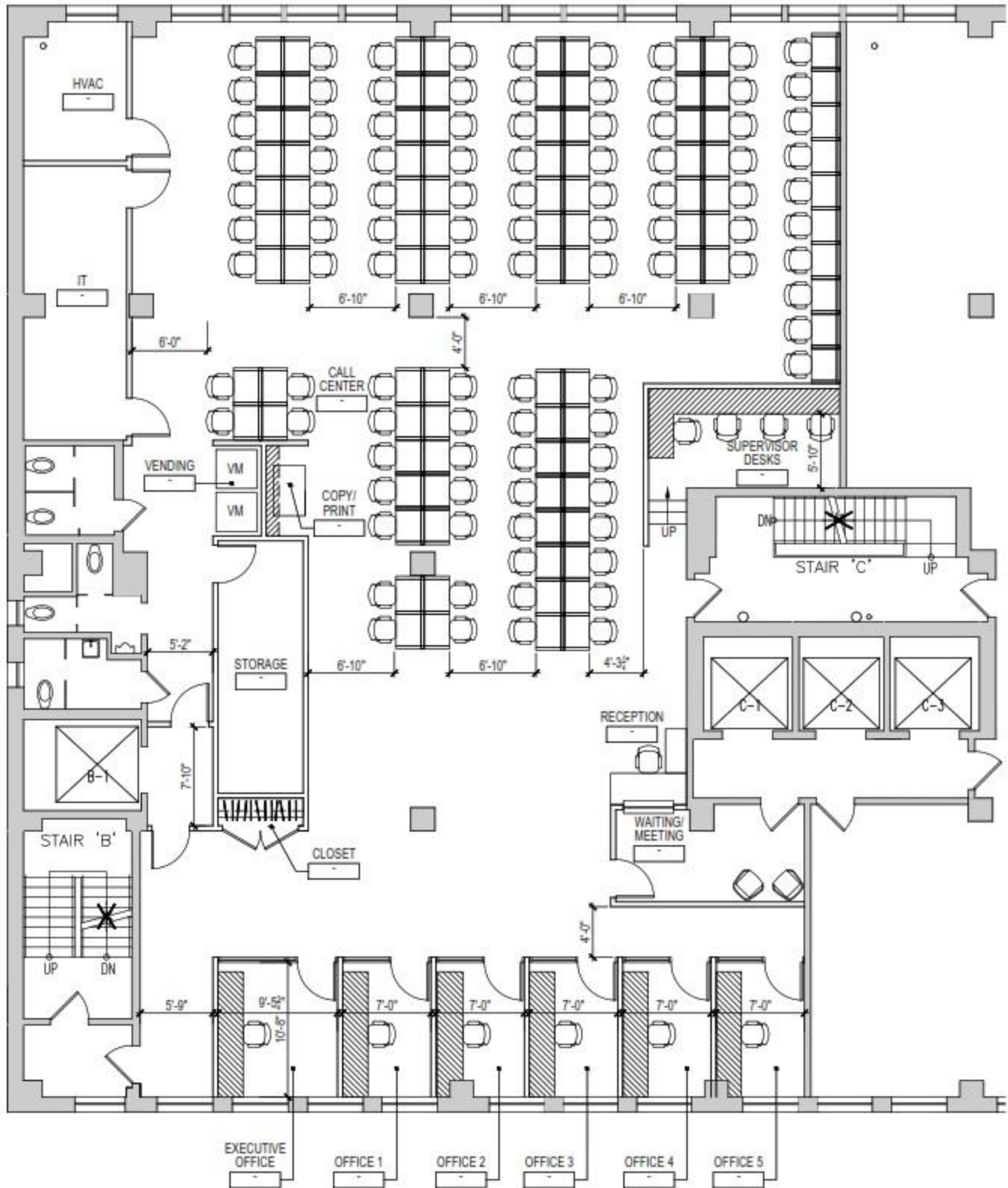

FEAT U R E D : 213 W E S T 35th S T R E E T

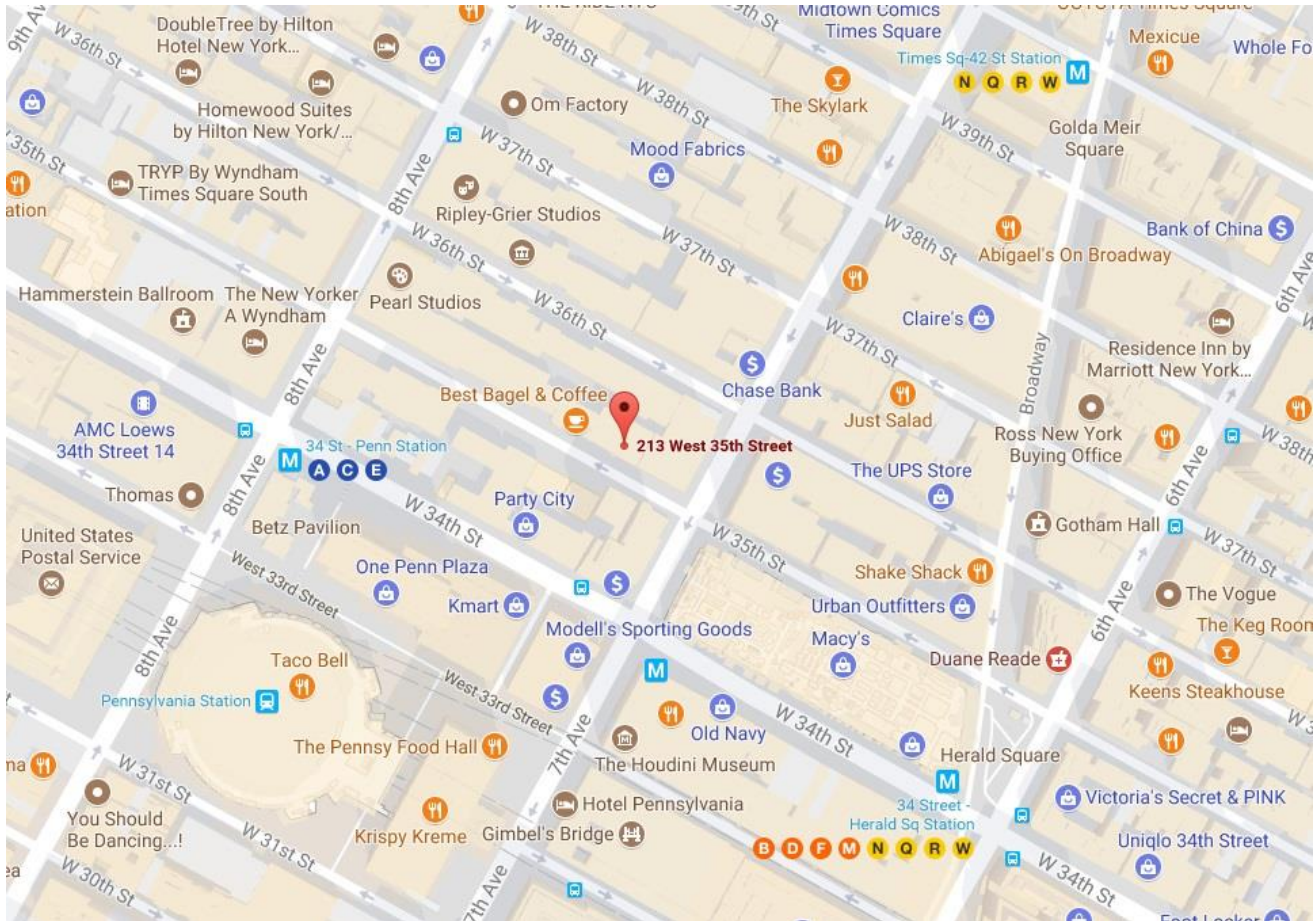

For more information of general inquiries contact

Joshua Smith

212 685 6400

jsmith@milsmith.com

Matt Mummert

765 376 9467

matthew@milsmith.com